

# PRODUCT DATA SHEET

## FULLY INSULATED FLAG POLYAMIDE DISCONNECTS



### DESCRIPTION

Flag Type Terminals, also known as slip-on or fast-on connectors, offer the fastest way to connect and disconnect two cables, they can also be reused. Simply slide the male terminal to the female terminal.

### FEATURES

- |                         |                                  |
|-------------------------|----------------------------------|
| - Standard              | : DIN 46237                      |
| - Material              | : Brass, Tin Plating             |
| - Insulation            | : Polyamide                      |
| - Operating Temperature | : Maximum From 105° to 600 Volts |

### MARKINGS



- It complies with RoHS standards.
- It complies with UKAS Quality Management standards.
- It complies with CE standards.
- It complies with UL standards.

# PRODUCT DATA SHEET

## FULLY INSULATED FLAG POLYAMIDE DISCONNECTS

### SECTIONS AND DIMENSIONS

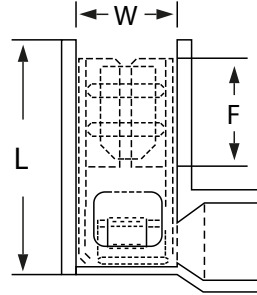

PRODUCT CODE	COLOUR	CABLE SECTION (mm <sup>2</sup> )	SOCKET WIDTH	DIMENSIONS (mm)		
				W	F	L
GPFDEB - 1861	<span style="color: red;">■</span> Red	0.50 - 1.50 mm <sup>2</sup>	0.8 x 6.35	6.6	7.6	16.0
GPFDEB - 2862	<span style="color: blue;">■</span> Blue	1.50 - 2.50 mm <sup>2</sup>	0.8 x 6.35	6.6	7.6	16.0